

cletech

Digital Signage Solutions

FX Totem Installation Guide

Step 1

- First of all, connection points should be created in the area where the product will be mounted.

- The dimensions required for the installation of the product on the floor are given.

- 8 units M20 Gijons will be fixed to the ground. The measure left out from the floor will be at least 210 mm.

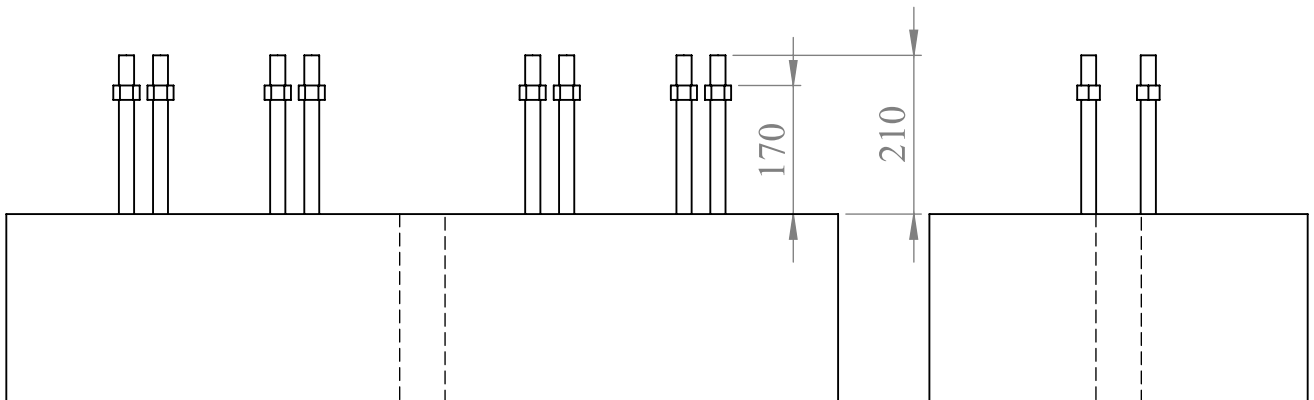
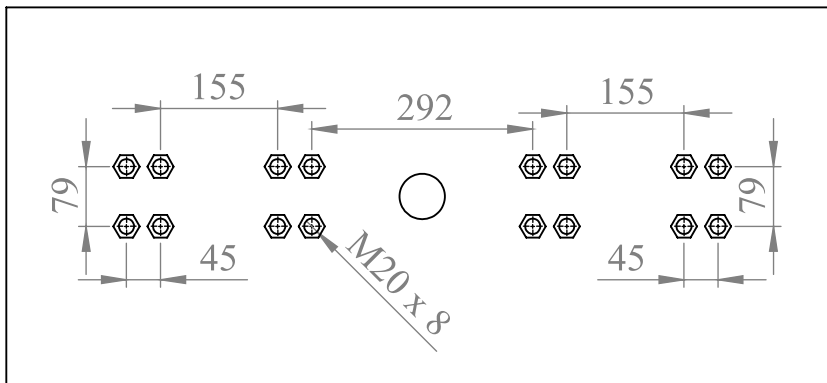
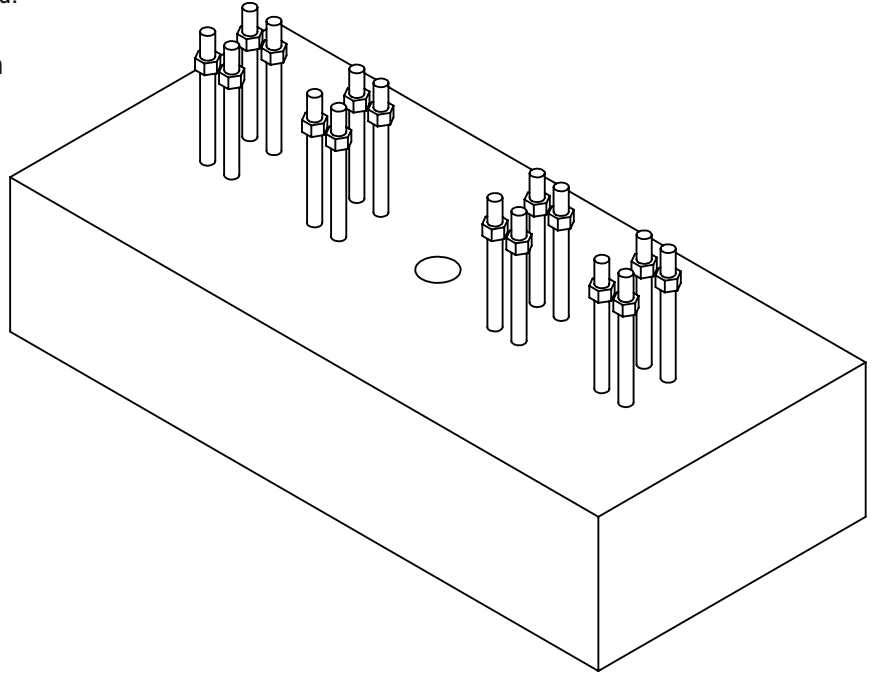

Step 2

- First, the vents located at the front and back of the product will be removed with a socket screwdriver that fits 4 units M4 nuts.

Socket
screwdriver.

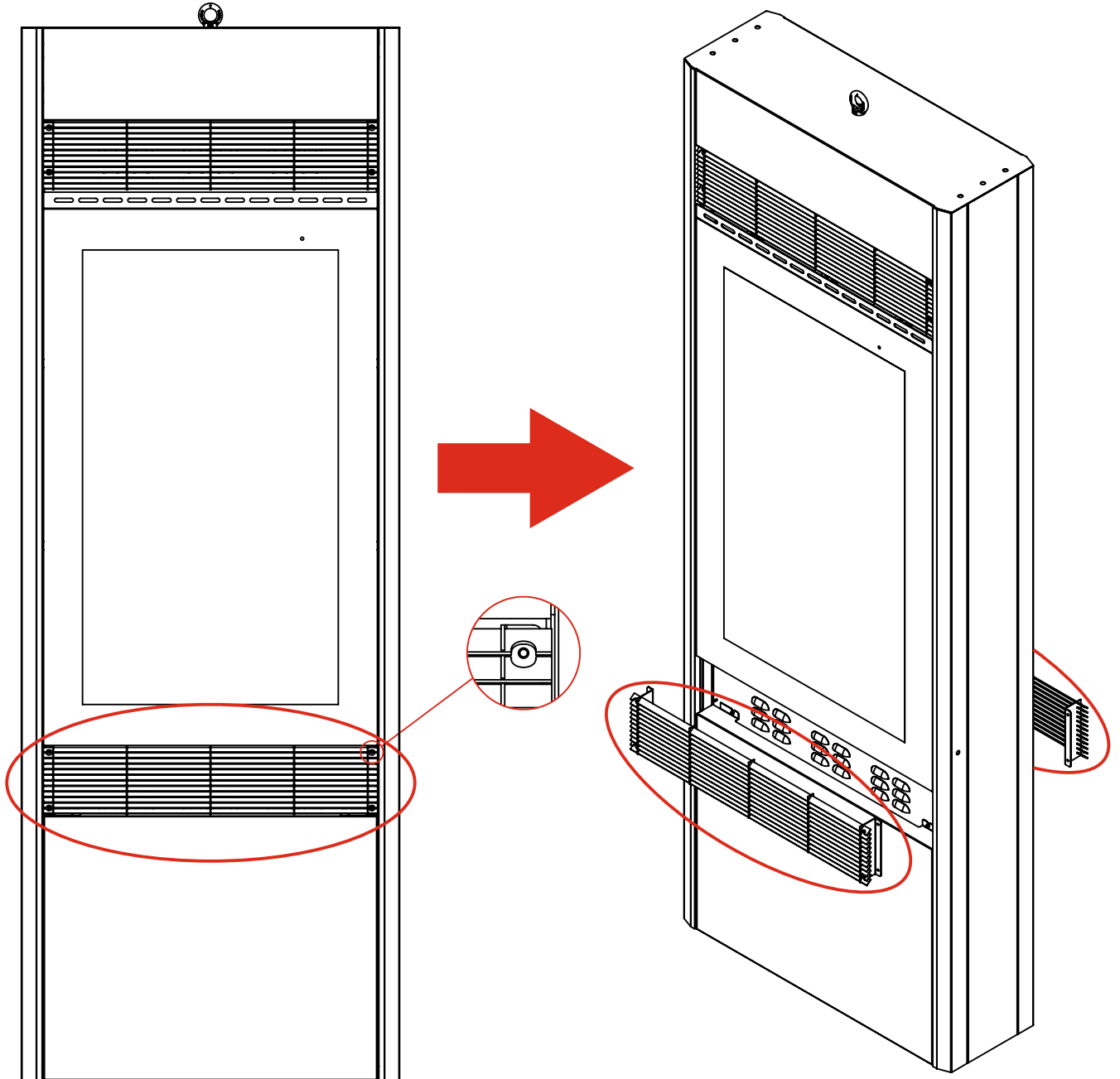
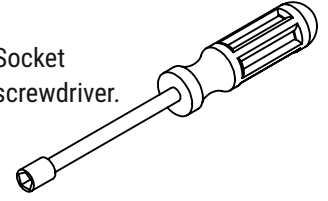

Step 3

- The bottom covers on the front and back of the product will be removed with a socket screwdriver suitable for 2 units M4 nuts.

Socket
screwdriver.

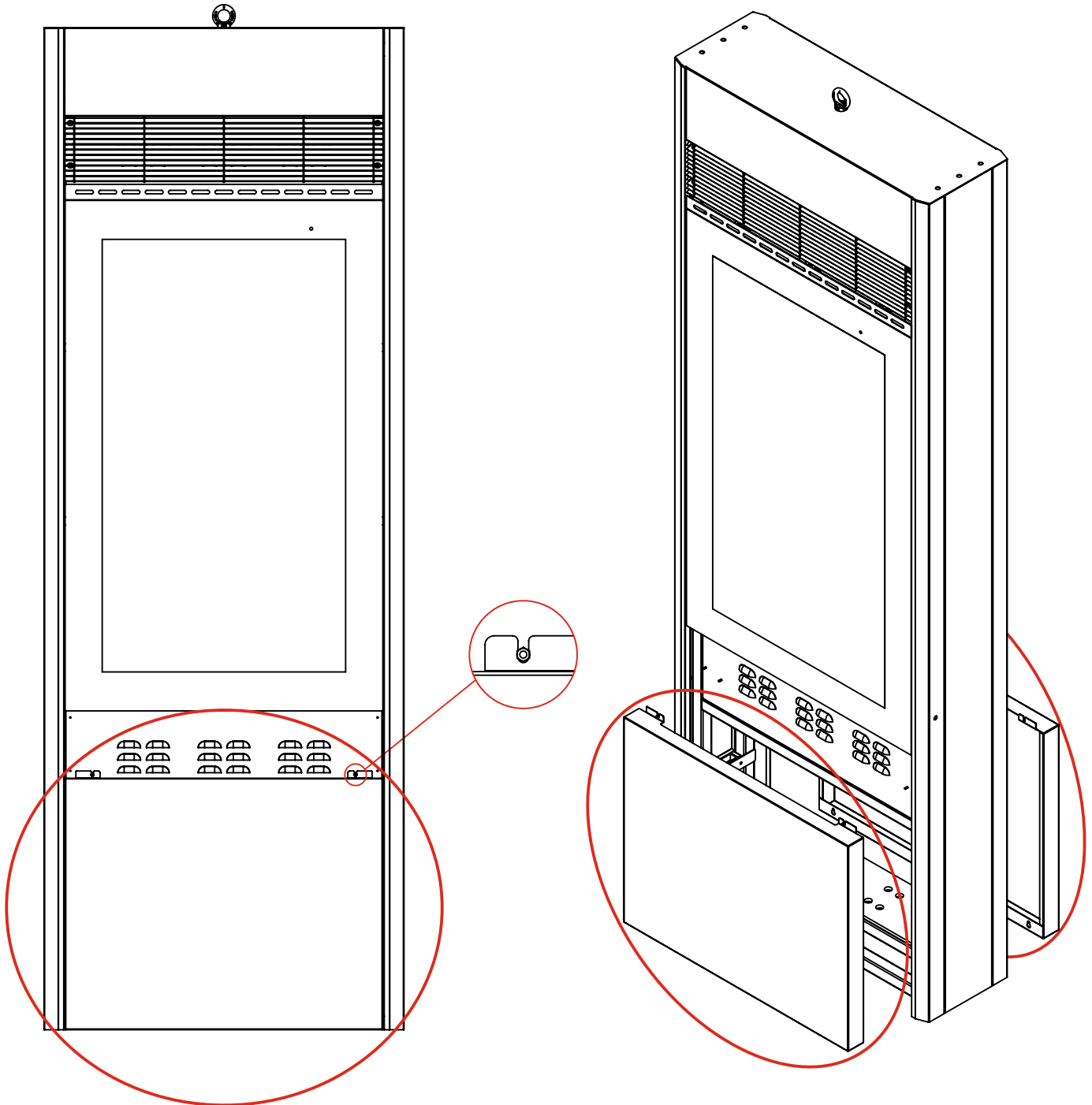
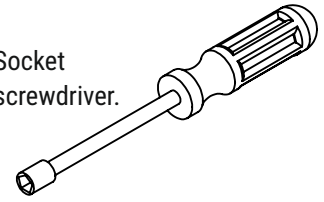

Step 4

- M16 Mapa is connected from the place marked on the product.
- Then the product is lifted off the ground by crane and rope.
- It is slowly left on the floor by coming on an anchorage that we have made in 1st step.

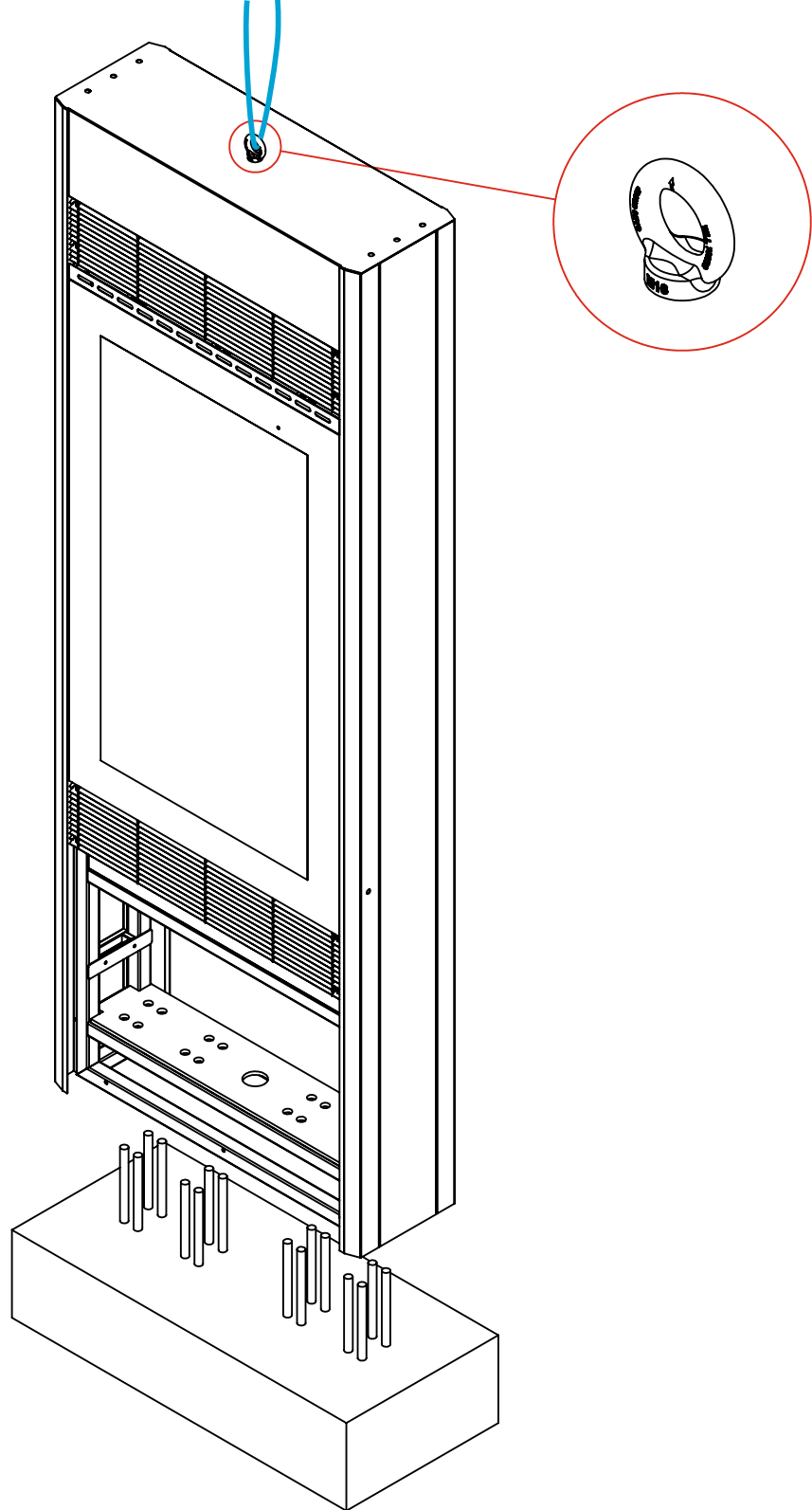

Step 5

- The product is fixed to the floor by tightening 16 units M20 Nuts.

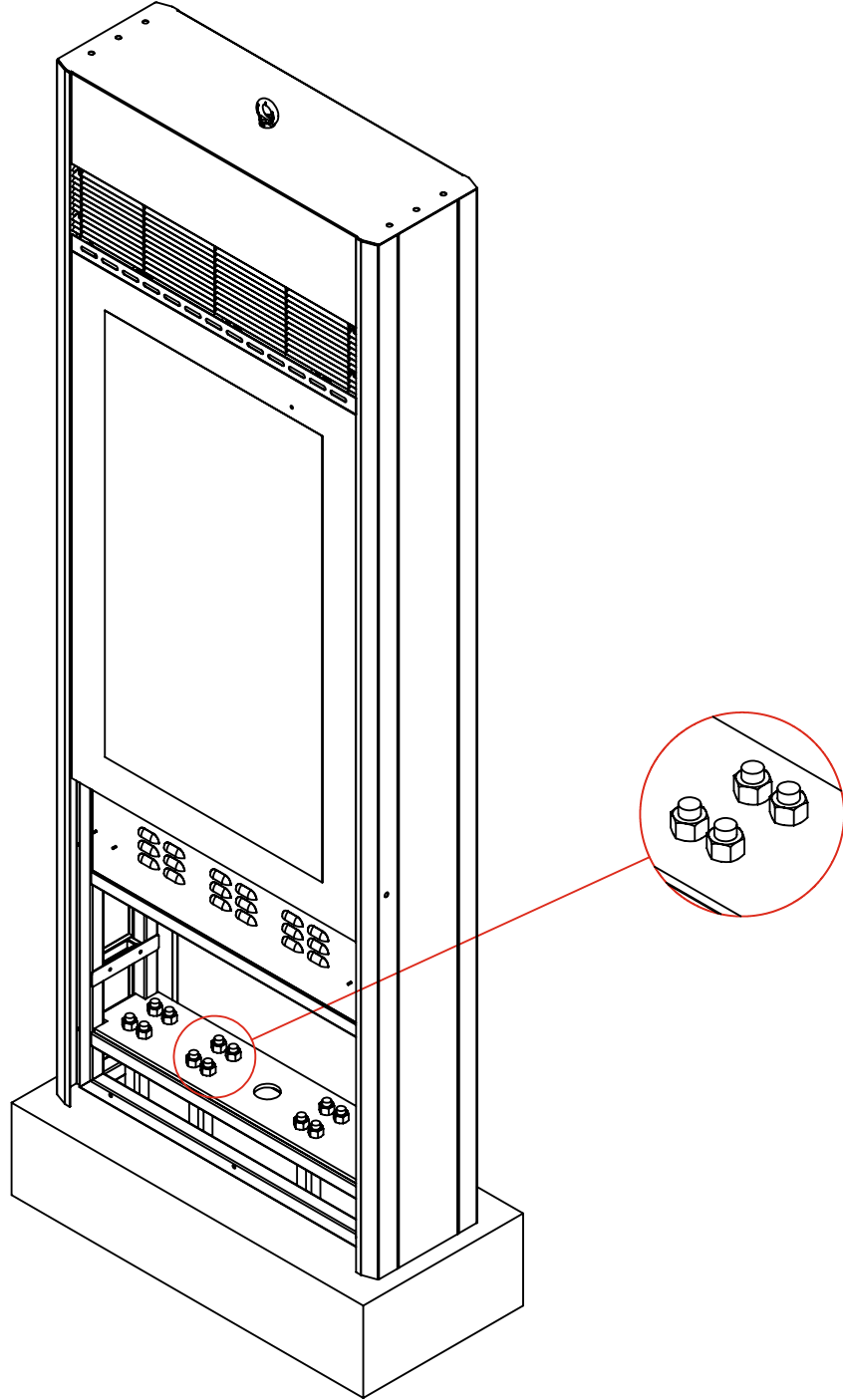

Step 6

- After completing the electrical and data connections, first replace the lower covers (1) and then the ventilation vents (2).

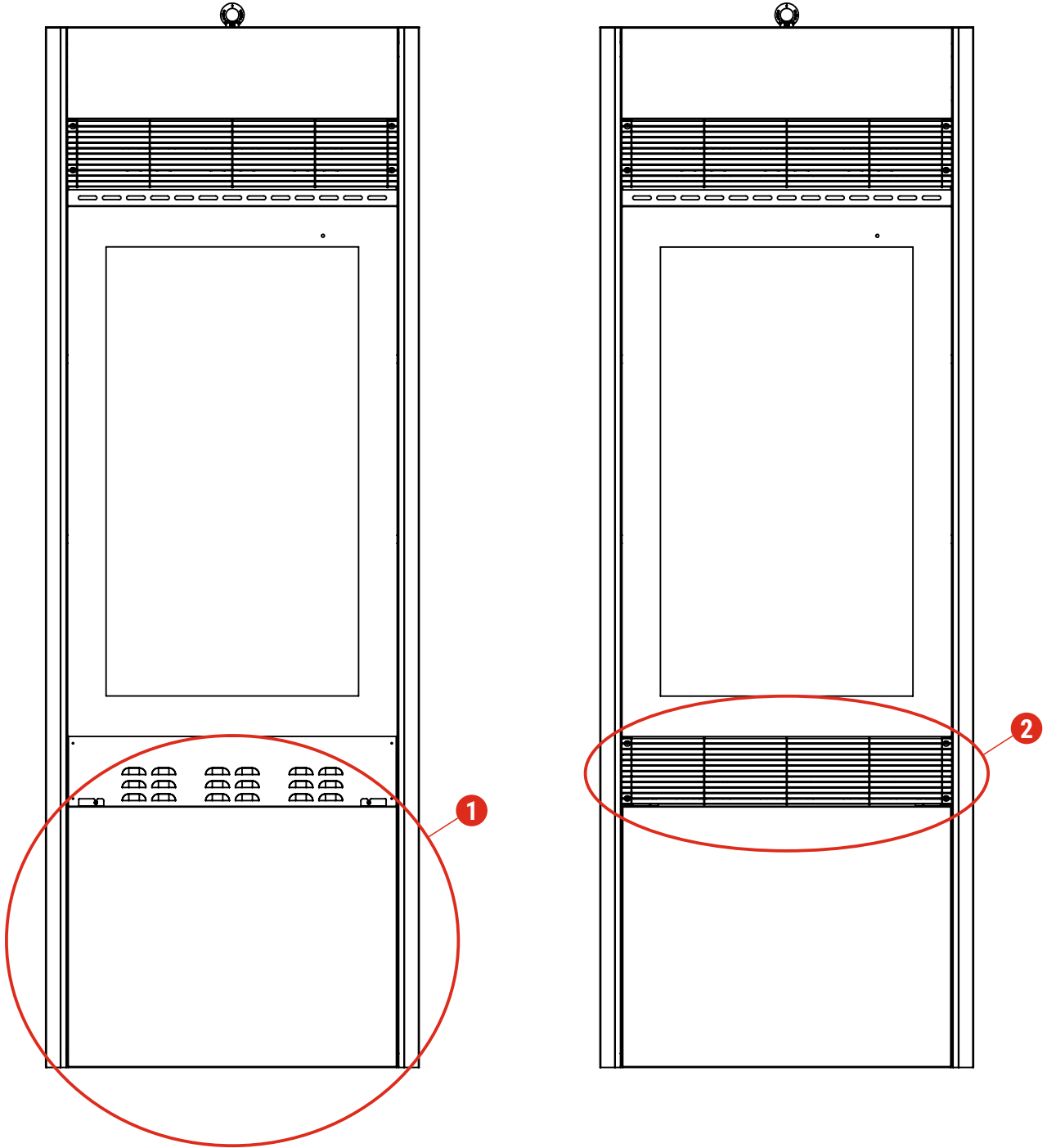

Step 7

- The key is inserted into the keyhole located on both sides of the product and the locks are unlocked.

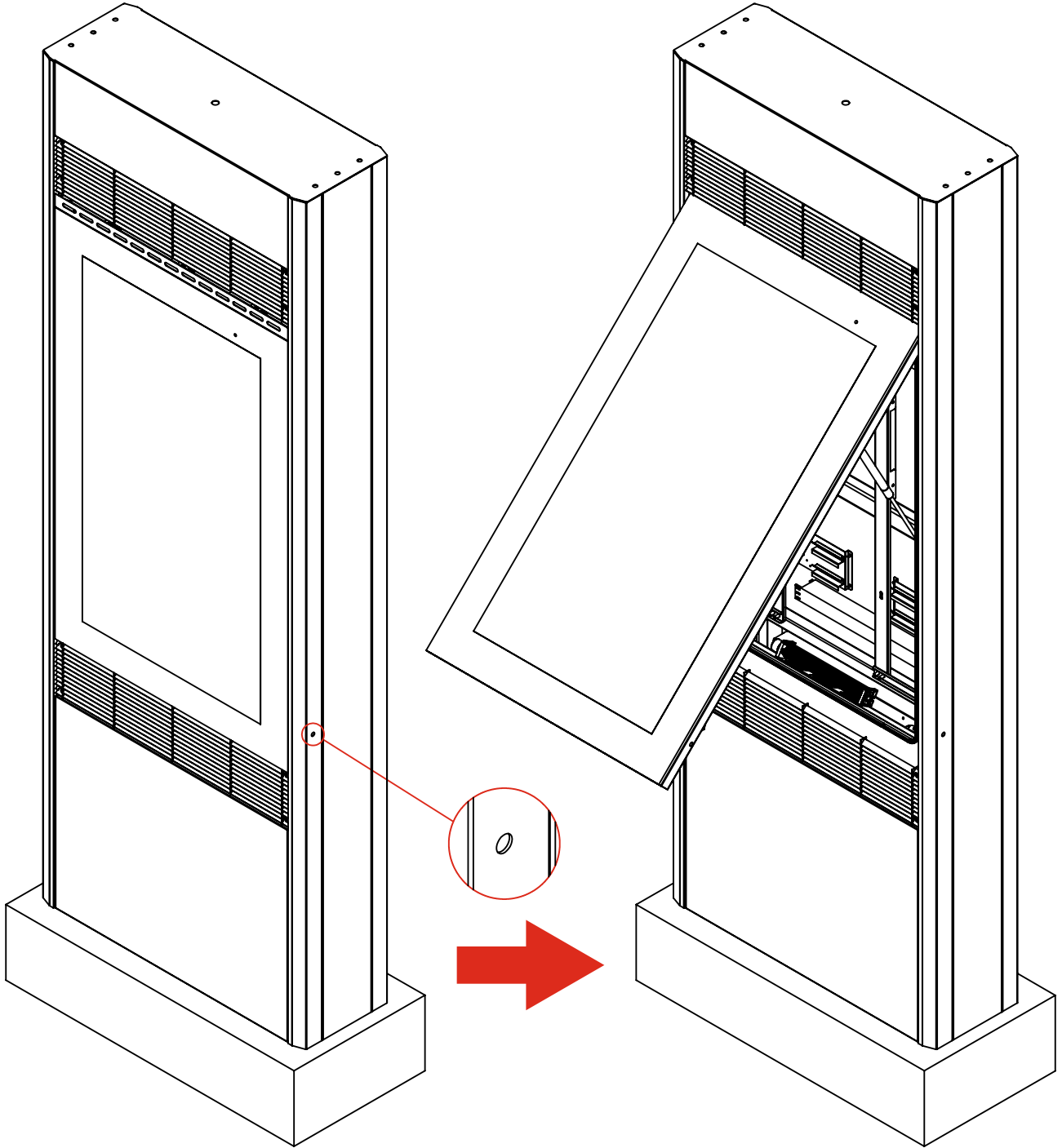

Step 8

- Remove the monitor hangers from the enclosure. (1)
- Hangers are installed on the monitor. (2)
- This part is the place of fixing the monitor to the enclosure. (3)

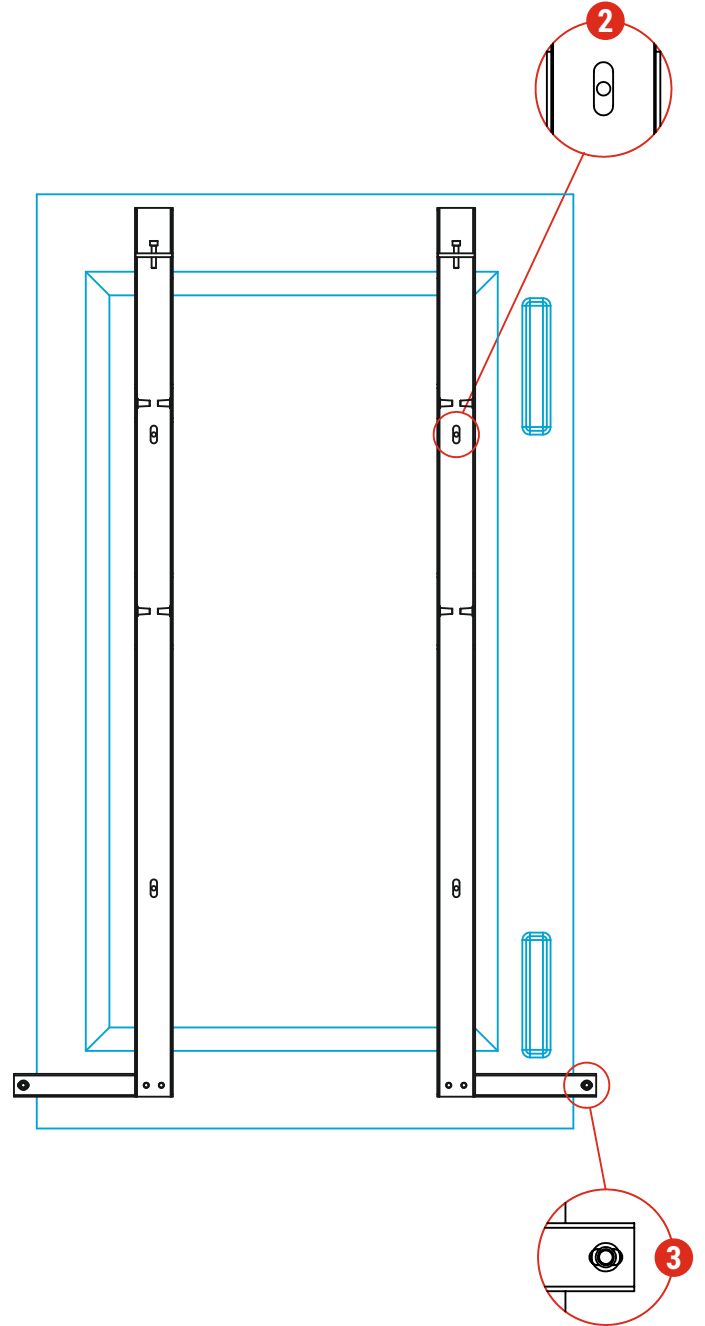
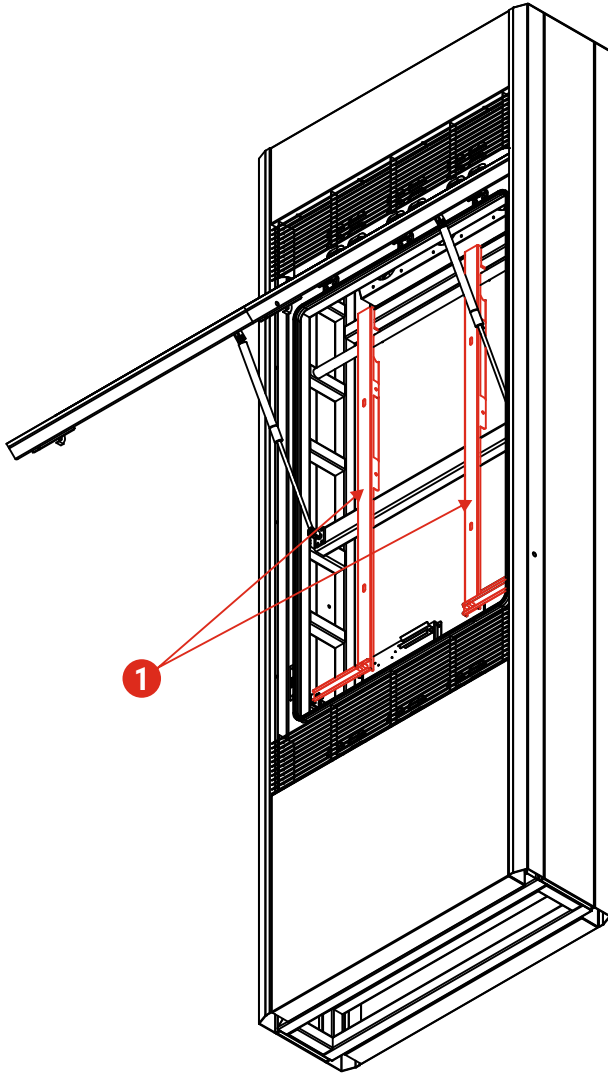

Step 9

- The monitors whose hangers are mounted are passed through the hangers inside the product as shown in the detail. (1)
- The monitor installed in the product is fixed to the enclosure on the marked places. (2)

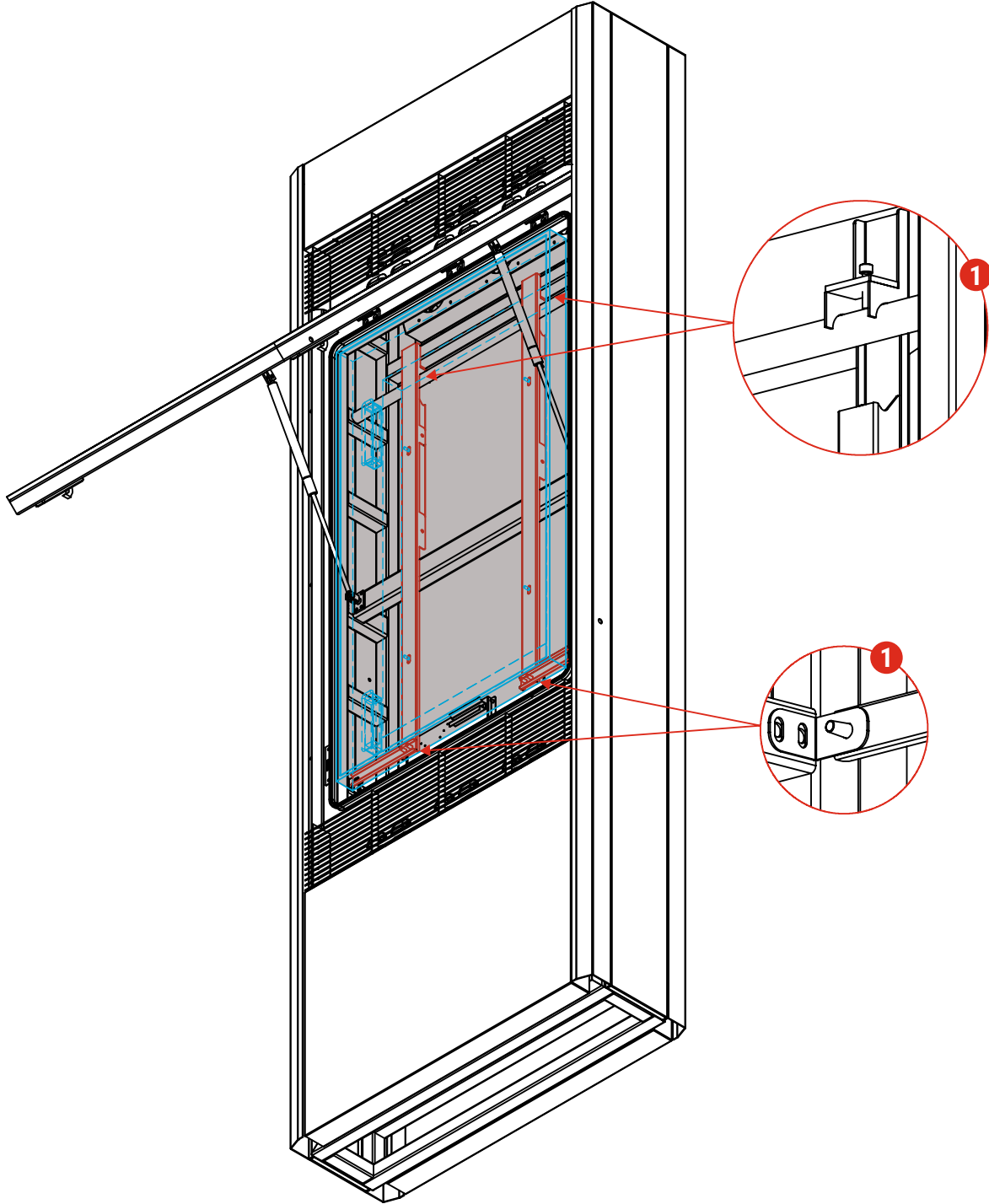

Step 10

- You can use the monitor hangers for service by placing them in the position shown below.

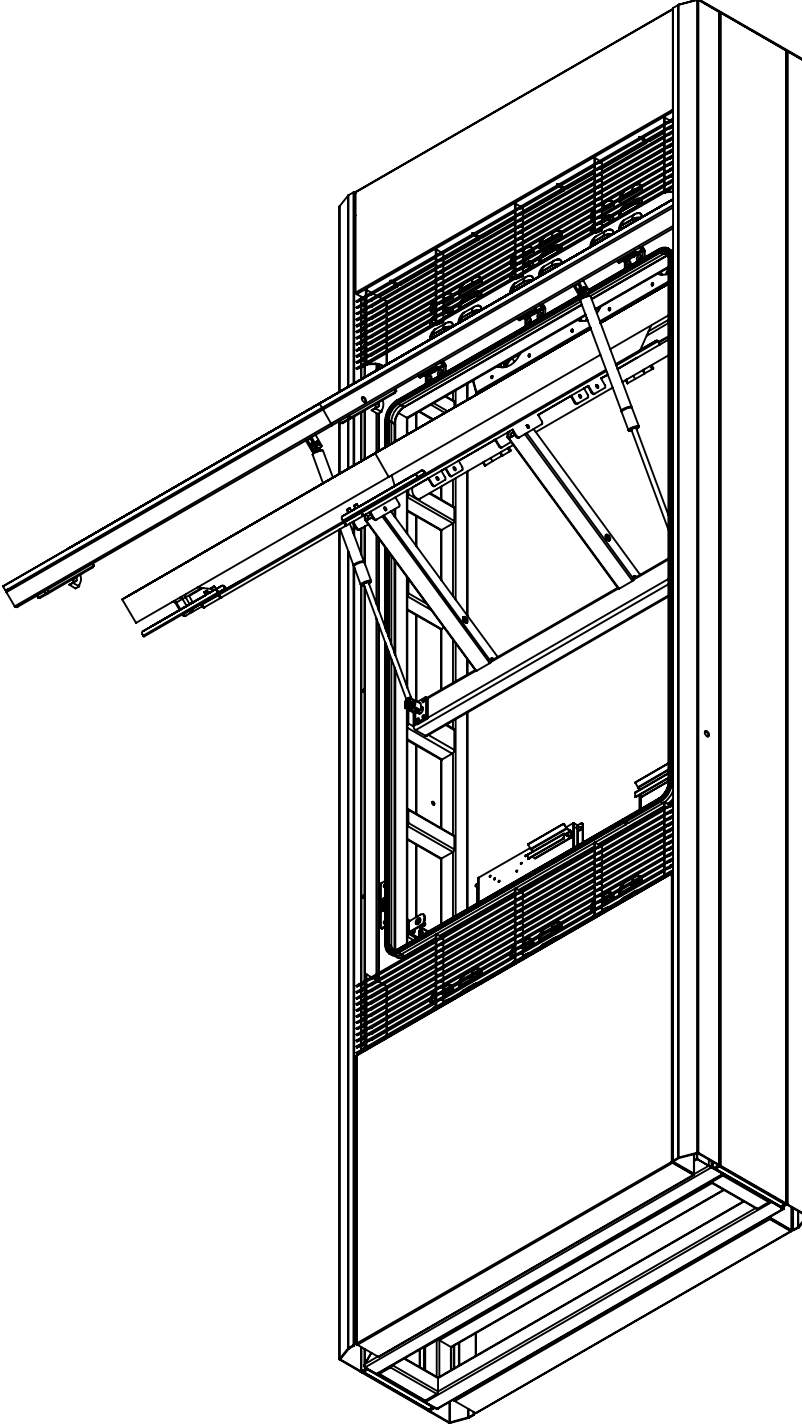

Step 11

- After the product power is on, it should be checked that all fans are working.
- Then the cover is closed and locked.

